



HyVibe Mobile Application User Guide

V0.2.0



LOGIN

CONTENTS

HYVIBE MOBILE APPLICATION V0.2.0

Login	1
Home Screen	2
Sidebar	3
Connections Screen	3-4
Settings	4
Bank Settings	5
Bank Library	6
Effect Modification	6
Preset Library	7
Preset Name	7
Metronome	8
Equalizer	8

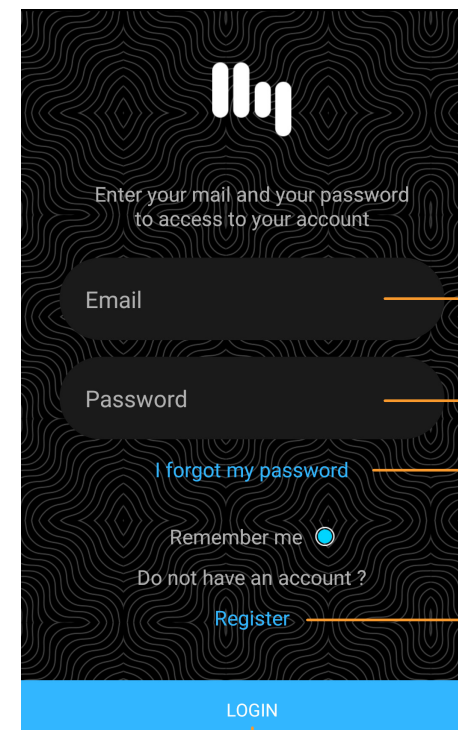

Enter e-mail and password to log in

Request lost password

Tap to create an account

Tap to Login



HOME SCREEN

Tap icon (or swipe right from the side of the screen) to open the Sidebar to access connections and settings

Tap the three dots to modify a bank or remove it from this screen

Switch active bank by pressing the bank tile (active bank is highlighted in blue)

Tap to access equalizer settings

Tap to activate looper mode

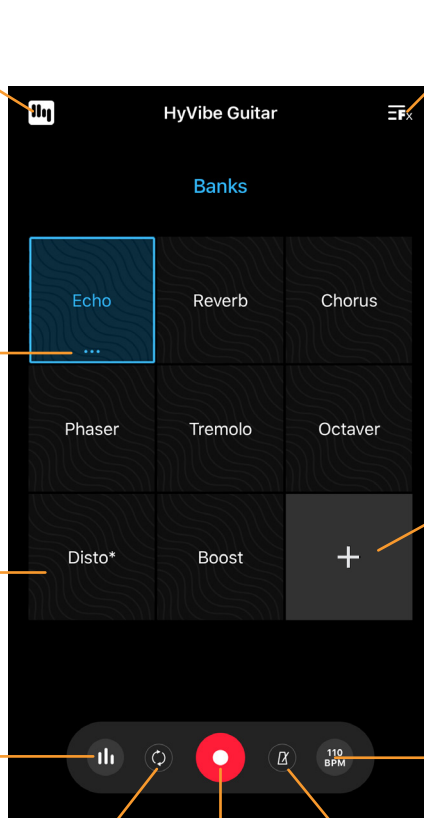

Tap to start/stop recording

Access Bank Library

Tap '+' in an empty bank to add a bank from the library. You can have 9 banks on the Home Screen. These banks sync with the guitar when it is connected with the app.

Tap to access Metronome and Looper settings

Tap to activate the Metronome

NOTE:

You can rearrange the order of the Banks on the screen by holding and dragging the Bank.

NOTE:

If looper mode is activated you will record a loop and the recording will replay automatically.

If looper mode is deactivated, the recording will continue until you press again to stop.



SIDEBAR

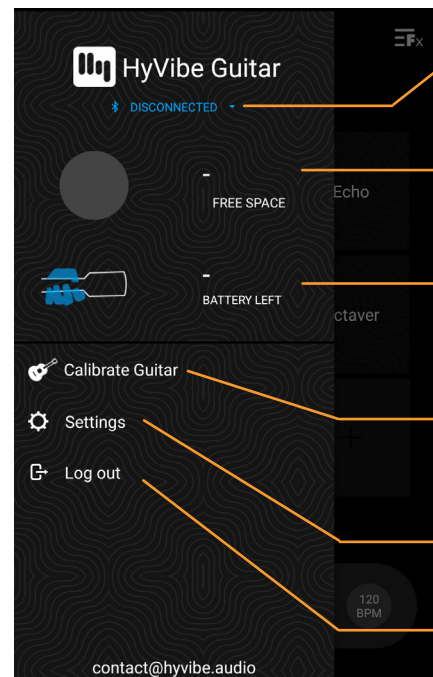

Your account e-mail address

Connection status:
displays the name of
the guitar currently
connected to the app. If
disconnected, press to
enter pairing screen.

Storage and battery levels
are currently inactive.

Refer to HyVibe System
interface for battery life.

Tap to enter
calibration screen

Tap to access Factory
Reset and About pages

Tap to log out

CONNECTIONS SCREEN

Disconnected State

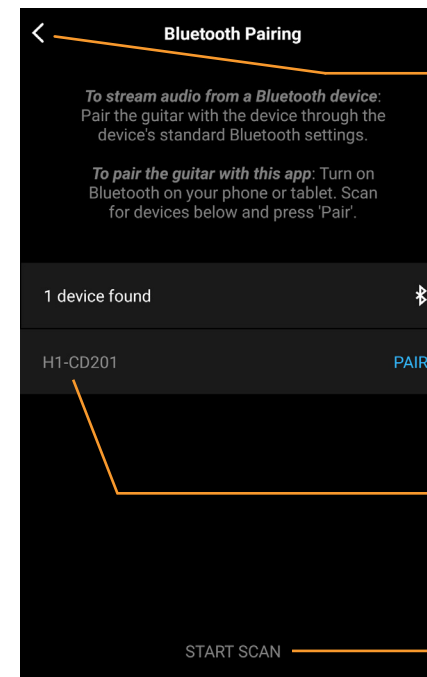

Tap to close screen

Tap to connect the app to
your guitar*

Guitar name (also found in
the System menu on the
HyVibe System's interface)

If the guitar is not displayed,
press 'Start Scan' to rescan

NOTE:

*Connecting the app with your guitar in this screen is only for using the app with the guitar (paired with Bluetooth Low Energy). If you wish to play music through the guitar, connect the guitar with your device's standard Bluetooth settings.



CONNECTIONS SCREEN

Connected State

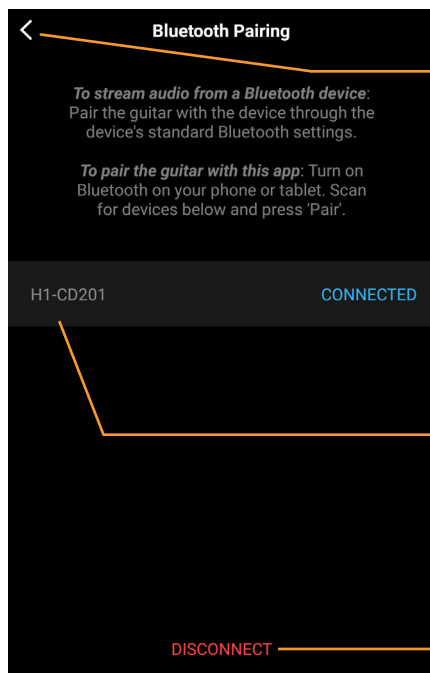

Tap to close screen

'Connected' means the guitar is connected to the app

Guitar name (you can also find the name of your guitar in the System menu on the HyVibe System's interface)

Tap to disconnect

SETTINGS

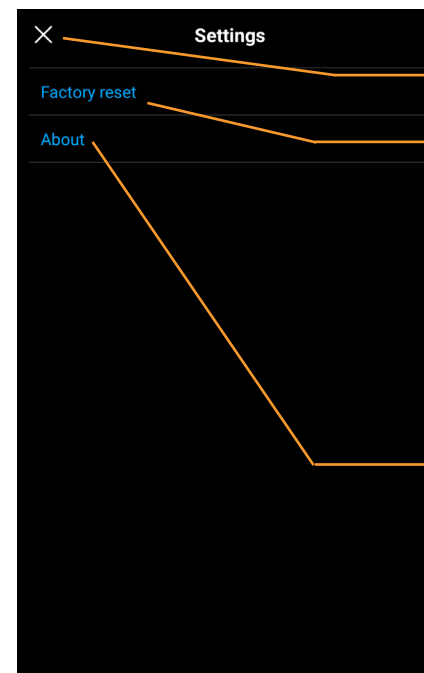

Tap to close screen

Tap to do a factory reset of the app. This will replace the current banks on the Home Screen with the default HyVibe banks on our server. Your custom banks will still be saved.

Tap to display App and Library versions



BANK SETTINGS

Tap to close screen

Tap on the title to rename a bank

Change the level by sliding the waveform up and down with your finger, or by pressing the +/- buttons

Activate Sustain Killer

Reset Sustain Killer, clearing the filter and rescanning frequencies

Swipe right to remove the effect from the bank

Tap 'Save' when creating a new bank. ('Save' does not appear when editing existing banks)

Tap '>' to edit effect

Name of preset effect in use - either a custom saved preset or default preset

Tap on empty field to add effect to bank

NOTE:

The effects are processed in series (starting from the top effect). Rearrange the order of processing by pressing down on the effect name and dragging it in the desired order.

SUSTAIN KILLER INSTRUCTIONS:

If there is unwanted sustain on the strings (auto vibration of the strings), enable the Sustain Killer. The HyVibe System will scan and find up to 10 frequencies (in under 2 seconds) that cause feedback and filter them out. If you turn the Sustain Killer off, the filter will be inactive. However, if you turn it back on, the previous frequency filter will be active again. If you press 'Reset', the HyVibe System will clear the filter and restart the scan.



BANK LIBRARY

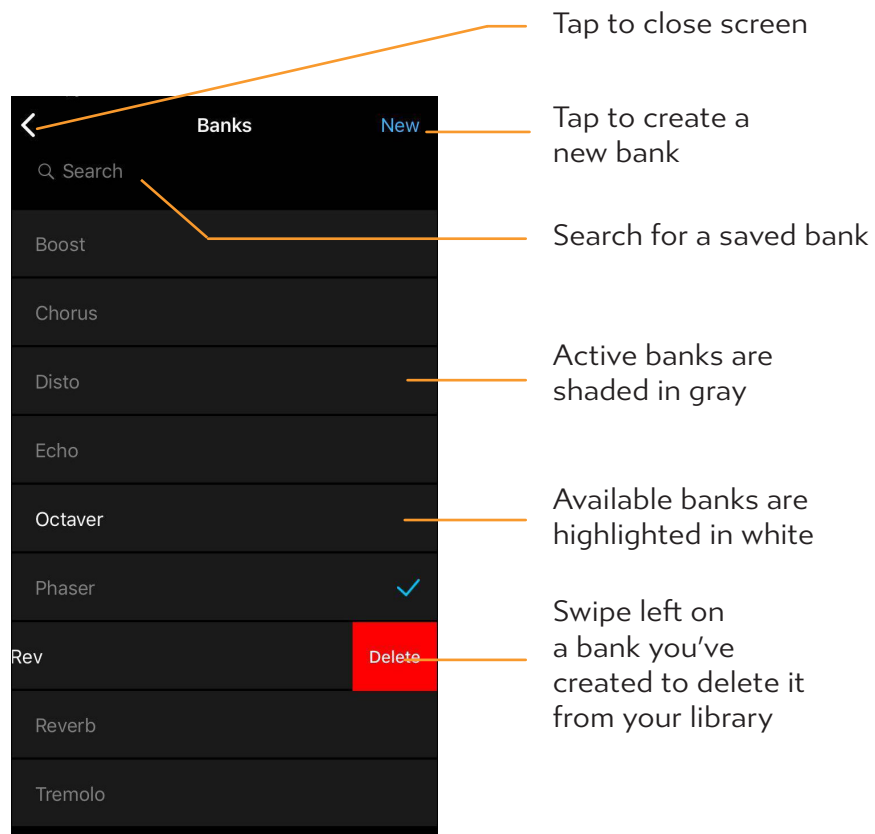

EFFECT MODIFICATION SCREEN

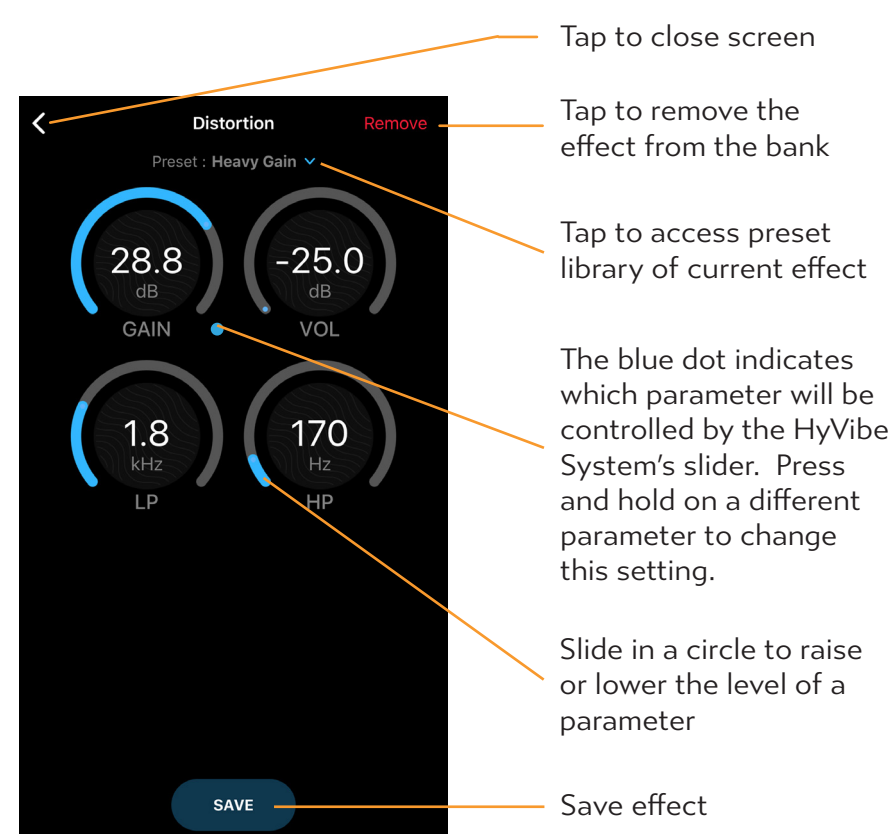



EFFECT PRESET LIBRARY

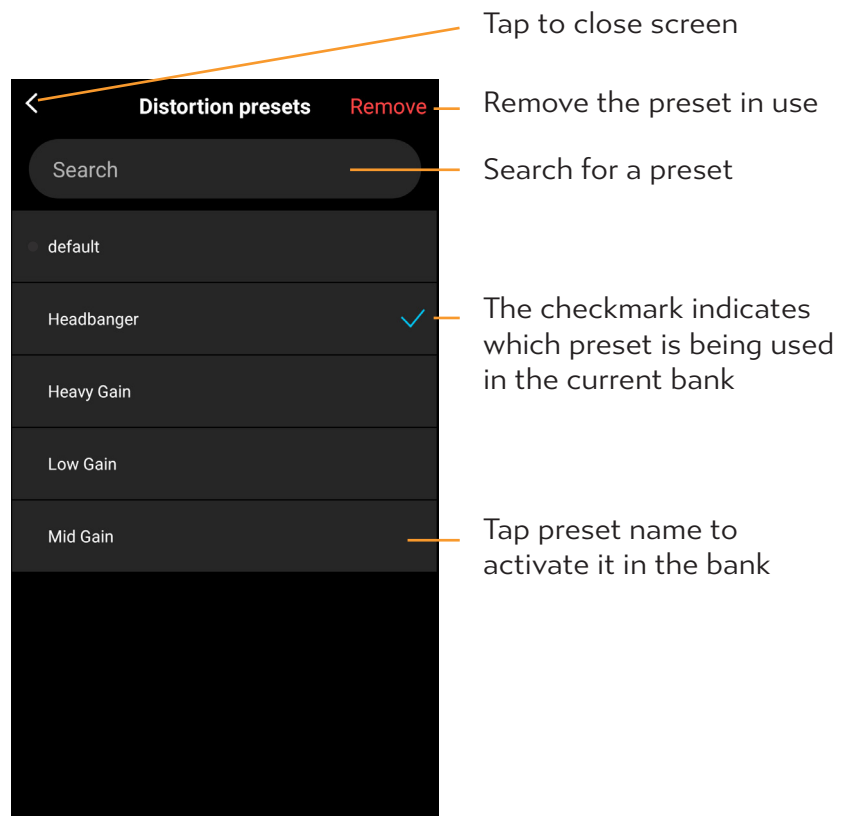

PRESET NAME SCREEN

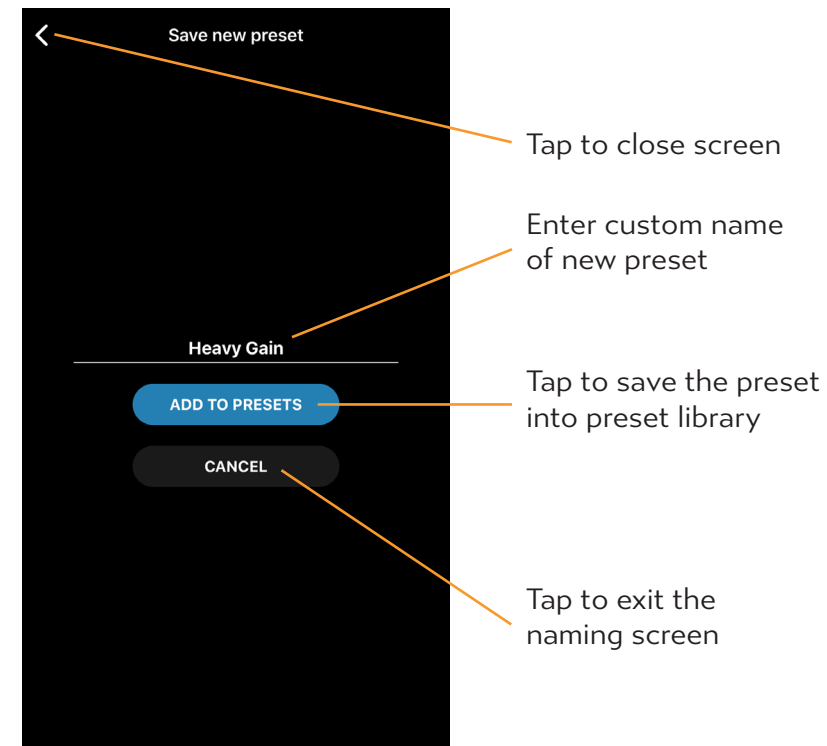



METRONOME SCREEN

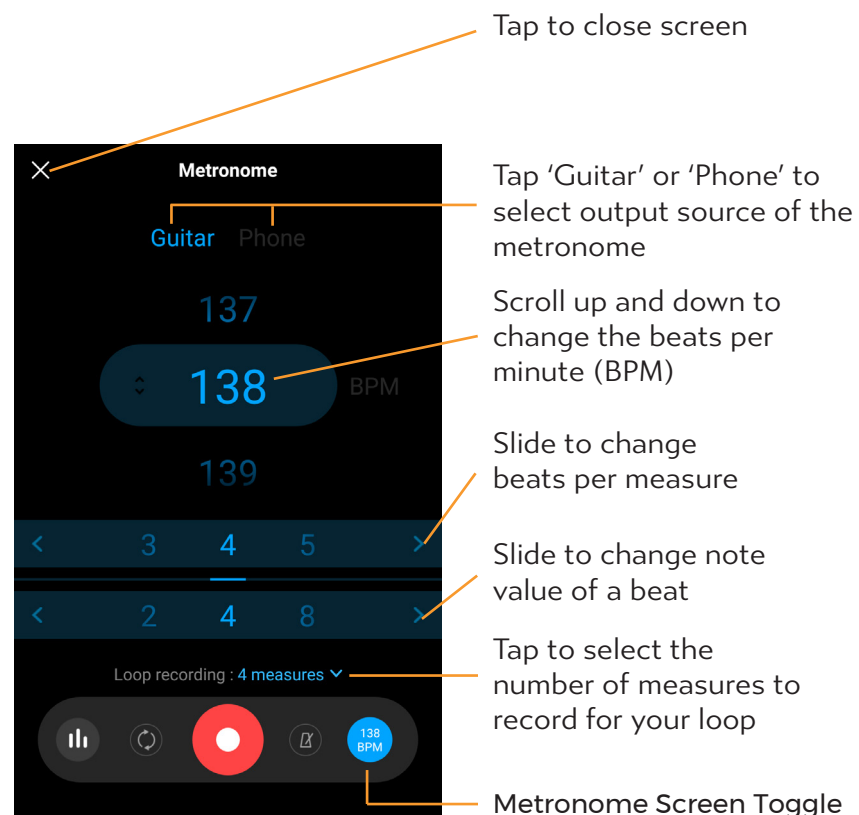

NOTE:

The looper settings sync with the HyVibe System memory when paired. The HyVibe System will save these settings even after disconnecting from your mobile device. If you are disconnected from the app, you will be able to modify the BPM and time signature on the HyVibe system, but not the length of the loop.

EQUALIZER SETTINGS

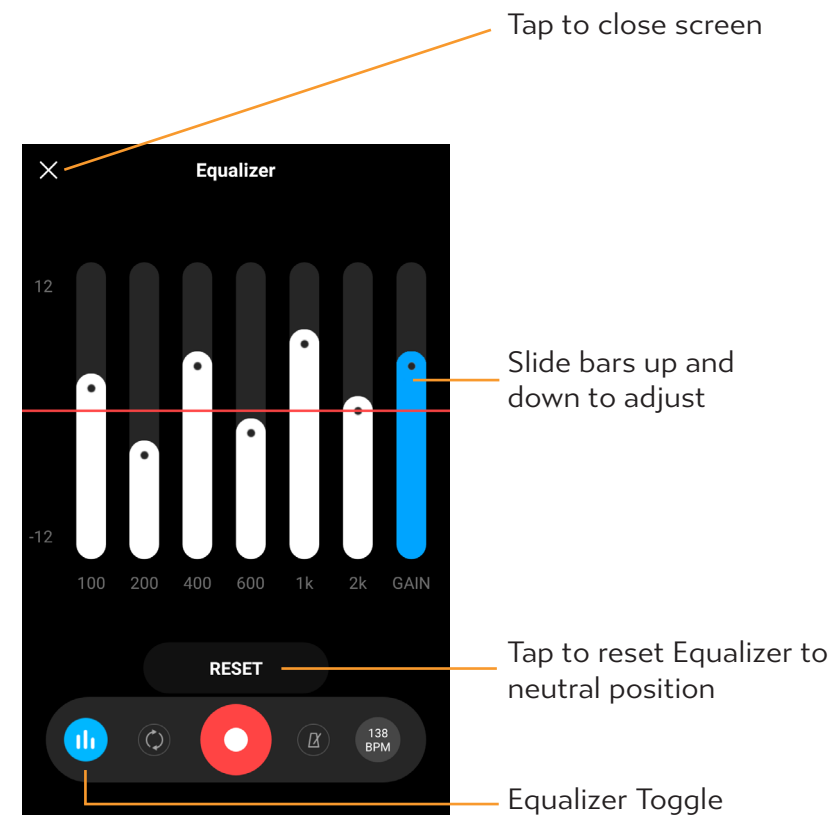

NOTE:

When the app is paired to the guitar, the Equalizer settings are applied to the effects, output, and looper. When unpaired, the last synced Equalizer settings will be applied to the guitar.